

# Units C-HC & F-HC

Physically Limited Tenant Floor Plans

2424 41st Street South  
Tacoma, WA 98409  
(253) 472-6281  
www.apexapartments.com  
info@apexapartments.com

### Unit C-HC

Area: 766 sf  
Featuring: 1 Master Bedroom, 1  
Bath & Den

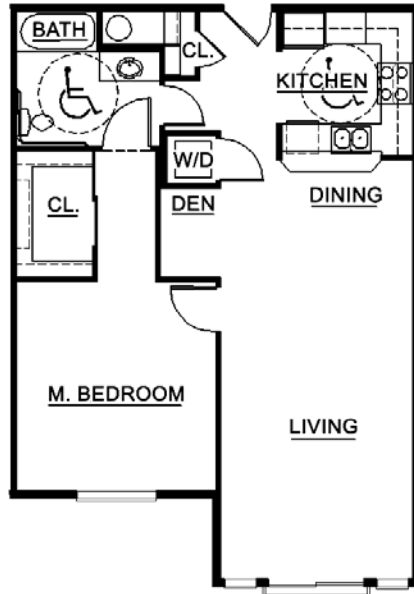

### Unit F-HC

Area: 1136 sf  
Deck: 58 sf  
Total: 1194 sf  
Featuring: 2 Bedroom (1 master),  
2 Bath, Study & Balcony

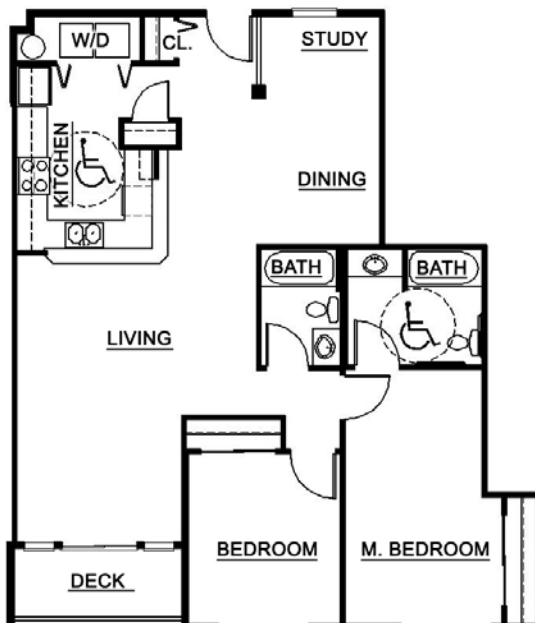

### Apartment Features

- Tile in entries and at sliding glass doors
- Kitchen features recessed panel hardwood cabinet doors with natural or cherry finish, stainless steel GE range, microwave/hood combo, refrigerator & dishwasher
- Breakfast bar
- Washer & dryer
- Glass railing at sliding glass doors
- Electronic entry access system allowing entry to all common areas
- Intercom access for visitors
- Quality wire closet shelving & pole systems throughout for maximum storage
- 1" aluminum mini-blinds at each window & sliding glass door
- Wired for high speed internet and is computer network ready